

State of Wyoming Corner Record

(In compliance with the *CORNER PERPETUATION AND FILING ACT*, Wyoming Statutes, 1997, Section 33-29-140, et seq., and the Rules and Regulations of the Board of Registration for Professional Engineers and Professional Land Surveyors)

Reverse side of this form may be used if more space is needed.

Record of original survey and citation of source of historical information (if corner is lost or obliterated). Description of corner monumentation evidence found and/or monument and accessories established to perpetuate the location of this corner. Sketch of relative location of monument, accessories, and reference points with course and distance to adjacent corner(s) (if determined in this survey). Method and rationale for reestablishment of lost or obliterated corner.

The General Land Office Townsite Survey for the "Survey of Cheyenne City" was issued under Contract No. 4 dated July 18, 1870; completed by Henry G. Hay and John B. Thomas, U.S. Deputy Surveyors on July 30, 1870; approved by Silas Reed, Surveyor General, Wyoming Territory on Aug. 11, 1870; presently recorded in the office of the U.S. Bureau of Land Management, Wyoming.

RECORD: NORTHWEST CORNER - "Set Stone 32 x 9 x 4 in Mound for N.W. Cor. (Red Sand Stone)".

FOUND: Stone of record; SEE - SURVEYOR'S REPORT on following pages.

SET: a 3 1/4" dia. brass cap atop the existing stone as a memorial, and encasing it within a 12" dia. cast iron street monument box.

See RECORD OF SURVEY recorded in the Laramie County Clerk's Office under Reception No. 606184, Bk. 2313, Pg. 41.

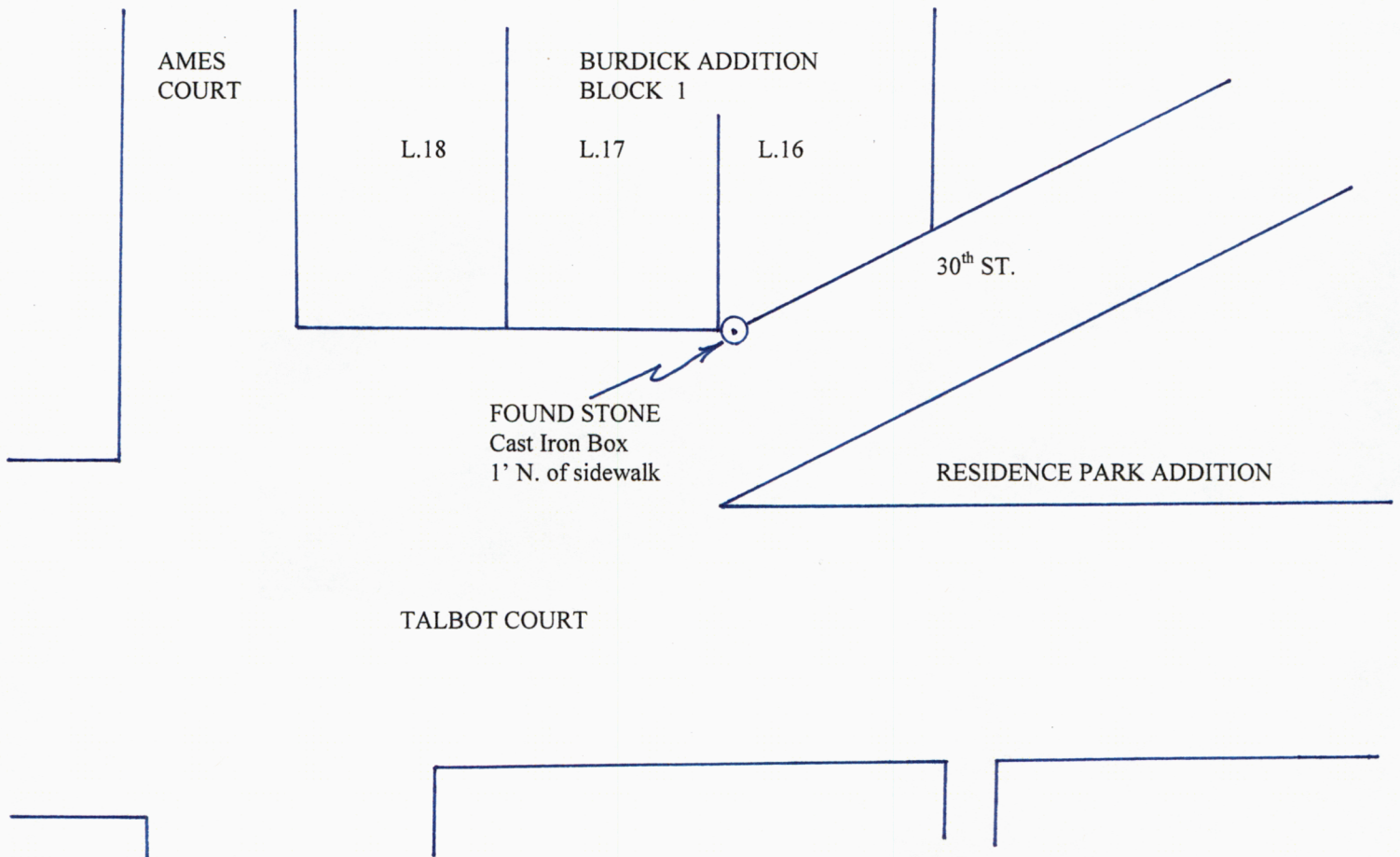

Date of Field Work: June 2011 Office Reference: _____

CROSS INDEX DIAGRAM

	1	2	3	4	5	6	7	8	9	10	11	12	13	14	15	16	17	18	19	20	21	22	23	24	25
A																									
B																									
C		6		5				4						3						2					1
D																									
E																									
F																									
G			7		8			9						10					11						12
H																									
J																									
K																									
L																									
M																									
N																									
O																									
P																									
Q																									
R																									
S																									
T																									
U																									
V																									
W																									
X																									
Y																									
Z																									

Land Surveyor / Firm / Address

John J. Studley, LS No. 4828

City of Cheyenne, City Surveyor

2101 O'Neil Ave., Room 206

Cheyenne, Wyoming 82001

Telephone: **307-637-6274**

This corner record was prepared by me or under my direction and supervision.
SEAL & SIGNATURE

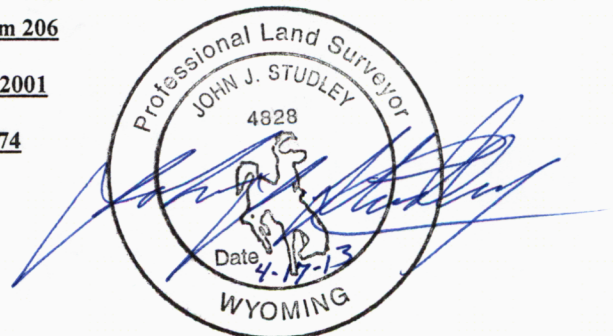

Corner Name: Northwest corner - GLO Townsite Survey of Cheyenne City located in the NE 1/4 of Section: 36 T 14 N R 67 W : 6th P.M.
Cross-Index No.: +/- W24 SBRPEPLS/PLSW: March 1994; PLSW January 1998

SURVEYOR'S REPORT

N.W. CORNER - G.L.O. SURVEY OF 1870 - Research for the original position of the northwesterly corner of the General Land Office (GLO) townsite survey of 1870 had indicated that this stone was gone and been replaced with modern metallic survey monuments. In fact, a modern day No. 5 rebar with a 1 ½" aluminum survey cap was found in the immediate area. But my measurements in the area kept producing discrepancies, which the area was well known to have. I had a "gut" feeling that I wanted to do more digging around the area to see if the stone might still exist.

The yards for these rental homes were not well kept, and when I called the respective land owners to tell them what I was doing, they granted permission to dig up their respective yards in my search. I referenced the found survey cap and excavated a 4' x 3' area x 18" deep on the northerly side of the found monument, to no avail. I found a couple of fence post remnants, but no stone or stone remnants.

I then started excavating south of the found survey cap, which was only about 3' from the sidewalk. The stone was found only five inches below the surface. Neatly chiseled on the southerly face of the stone was "NW". The GLO notes described the stone as "*Set Stone 32 x 9 x 4 in mound for NW Cor. (Red Sand Stone)*".

I backfilled the northerly excavated area, and further excavated around the found stone for the purpose of setting a brass cap atop the stone as a memorial, and encasing it in a 12" diameter cast iron street monument box, for easy access in the future.

RECORDED PLATS OR REFERENCES

- AMENDED PLAT OF RESIDENCE PARK ADDITION - OCT. 8, 1921
- BURDICK ADDITION TO CHEYENNE - MAY 29, 1940



Figure 1 - Original stone monument uncovered.



Figure 2 - Chiseled "NW" visible.



Figure 3 - 3 ¼" Brass Cap and cast iron box set over found stone.